

NP-1660MD Medical DICOM Printer

Product Description

The NP-1660MD Medical DICOM Printer is an intelligent, dye-diffusion/direct thermal dual mode, color and grayscale output device which provides both 10Mb/s and 100Mb/s Ethernet and Centronics compatible parallel interfaces. In addition to DICOM, the printer accepts many industry standard file formats and includes built-in image processing and spooling capabilities.

Specifications

Print Technology:	Dye-diffusion and direct thermal.
Resolution:	300 dpi (11.8 pixels/mm).
Color Output:	16.7 million colors 256 levels each of cyan, magenta, and yellow (optional laminate overcoat).
Grayscale Output:	256 levels, dye-diffusion and direct thermal media support.
Media Sizes:	7 sizes; from 8 x 10 in. to 8.5 x 14 in.
Media Types:	ChromaVista™ Paper (color or B&W). ChromaVista™ Transparency (color). DirectVista™ Film (clear or blue). DirectVista™ Paper (B&W).
Density Range:	Media dependent, see media carton for specifications.
Interfaces:	Ethernet: AUI 15-pin connector. 100Base-T / 10Base-T RJ-45. Parallel: Centronics type 36-pin connector. Optional: M-O Drive, 3.5 inch.
Image Formats:	Standard: TIFF, GIF, PCX, BMP, PBM, PGM, PPM, XWD, JPEG, Sun Raster, SGI RGB, Targa, and DICOM 3.0. Optional: DEFF, PostScript.
Image Scaling:	Box, Bilinear, Bicubic, Mitchell, Lanczos, Sharp1, Sharp2, Sharp3, software selectable.
Image Rotation:	90 degrees, software selectable.
Image Correction:	Gamma, contrast, antialiasing (PostScript), TCR, Medical Color Matching, selectable from front panel or via software.
Image Formatting:	Variable Multiformating (VMF), Fixed Multiformating (FMF), 35mm SlideMaker, Captions, and Bracketing.
Front Panel:	16-character LCD, Power, and Fault indicators, Online and Cancel buttons.
Memory:	64MB (16MB RAM, 48MB virtual).
Disk:	2.1 GB (1.5 GB available for spooling).
Floppy Drive:	Built-in for software upgrades.
Cassettes:	One adjustable cassette included with printer. 100 sheet capacity, paper, film or transparency. Single sheet bypass feed.
Power:	Autosensing; 100-120V~, 250W printing, 125W idle 200-240V~, 250W printing, 125W idle.
Weight:	60 lbs.
Dimensions:	12" H, 17" W, 21" L.
Regulatory:	UL, CUL, TUV, CE, FCC.
Environment:	Operating: 15-30°C, Storage: -25-70°C Operating Humidity: 20-76% Storage Humidity: 5-95%

Printer and Cassette



Back Panel

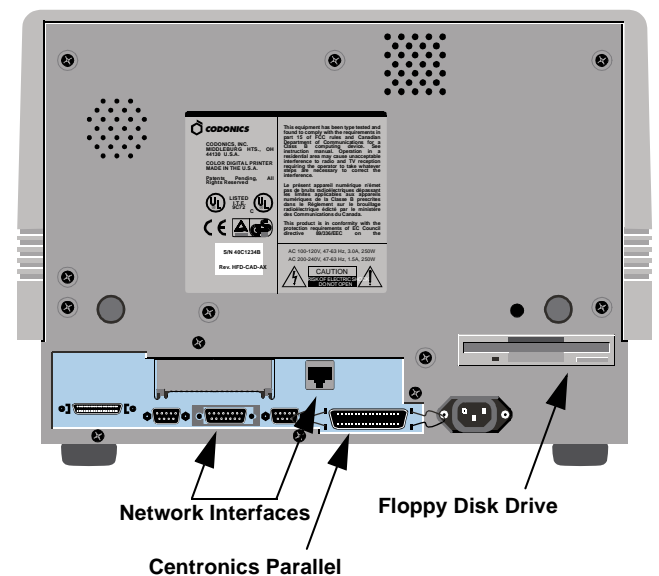

Get it all with just one call
1-800-444-1198



We bring the future into focus

17991 Englewood Drive
Middleburg Heights, OH 44130 USA
(440) 243-1198
(440) 243-1334 Fax
Email info@codonics.com
www.codonics.com